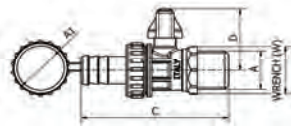
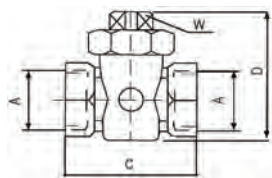

Art.477/N Rubinetto sfera scarico caldaia M.Cromato *Chromium plated Ball valve boiler discharge M.*

Misura	A	A1	W	C	D	gr.	box	€
1/2"	1/2"	3/4"	25,5	67	35	101	12	5,34

Corpo in ottone CW617N cromato
Leva in Alluminio nera
Girello e portagom. in ottone CW617N
Catenella in NBR. Guarnizione
Pressione di esercizio 16 bar
Massima temperatura 90°C

*Body in CW617N, chromium plated
Arm in black Aluminium
Ring nut and hose connector in CW617N
Chain in NBR. Gasket
Working pressure : 16 bar
Maximum temperature 90°C*

Art.476 Scarico caldaia F.F. *Automatic air-discharger valve PN 10*

Misura	A	W	C	D	gr.	box	€
3/8"	3/8"	10	40	41		10	5,40
1/2"	1/2"	12	45	46		109	6,00
3/4"	3/4"	14	56	56		5	12,00

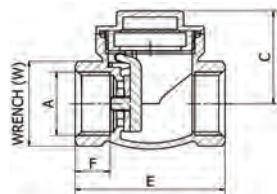
Art.435 Valvola clapet sede metallo PN 25 *Clapet valve Metal seat PN 25*

Misura	A	F	W	E	C	gr.	box	€
1/2"	1/2"	11,5	25	46,5	32,5	143	30	7,77
3/4"	3/4"	12	30	52	35,5	217	20	10,26
1"	1"	13	38	64	39,5	331	10	15,06
1.1/4"	1.1/4"	14	47	74,5	44,5	448	6	22,14
1.1/2"	1.1/2"	18	54	86	54,5	731	5	27,06
2"	2"	16	66,5	97	158	1038	2	38,79
2.1/2"	2.1/2"	18,5	81,5	116	62	1480	1	63,81
3"	3"	20	97	137	74	2410	1	84,42
4"	4"	20,5	122	165	95	3950	1	138,27

Corpo, tappo e otturatore in CW617N
Sede metallica
Installazione su tubazione orizzontale

*Body, bonnet, shutter in CW617N
Metallic seat
Installation on horizontal pipe*

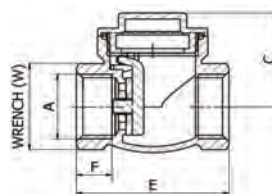
Art.440 Valvola clapet sede gomma PN 25 *Clapet valve Rubber seat PN 25*

Misura	A	F	W	E	C	gr.	box	€
1/2"	1/2"	11,5	25	46,5	32,5	143	30	7,77
3/4"	3/4"	12	30	52	35,5	217	20	10,26
1"	1"	13	38	64	39,5	331	10	15,06
1.1/4"	1.1/4"	14	47	74,5	44,5	448	6	22,14
1.1/2"	1.1/2"	18	54	86	54,5	731	5	27,06
2"	2"	16	66,5	97	158	1040	2	38,79
2.1/2"	2.1/2"	18,5	81,5	116	62	1480	1	63,81
3"	3"	20	97	137	74	2410	1	84,42
4"	4"	20,5	122	165	95	3950	1	138,27

Corpo, tappo e battente in ottone
Sede gomma NBR
Installazione su tubazione orizzontale

*Body, bonnet, shutter in CW617N
Rubber seat
Installation on horizontal pipe*